

# SETTING UP YOUR CHILD'S IPAD

**A quick 'how-to' with setting up family sharing and  
managing technology restrictions**

Bellaire PS

# FAMILY SHARING AND APPLE ID FOR YOUR CHILD

With Family Sharing, you can create an Apple ID for your child. This allows them to participate in Family Sharing and use other Apple services such as iCloud, iMessage, FaceTime and Game Center whilst at home.

The below website and next slide outlines apples step by step process to set up a apple ID for your child.

<https://support.apple.com/en-au/HT201084>

# IPHONE OR IPAD

1. Go to Settings > [your name] > Family Sharing > Add Family Member > Create a Child Account > Next
2. Enter your child's birthday and tap Next. Be sure to enter the correct date — you can't change it later.
3. Review the Parent Privacy Disclosure and tap Agree.
4. Enter the requested information for your payment method and tap Next. If you don't have a payment method on file, [you need to add one](#).
5. Enter your child's name, tap Next, then create their Apple ID (username@icloud.com) and tap Next. Tap Create.
6. Follow the onscreen instructions to set a password, choose security questions and set up your child's account. Choose passwords and security questions that you can both remember.
7. Turn on Ask to Buy to approve all iTunes Store, Apple Books, and App Store purchases initiated by your child. You are responsible for all charges to your account. Tap Next.
8. Review the Terms and Conditions. Tap Agree

# WHERE TO START...

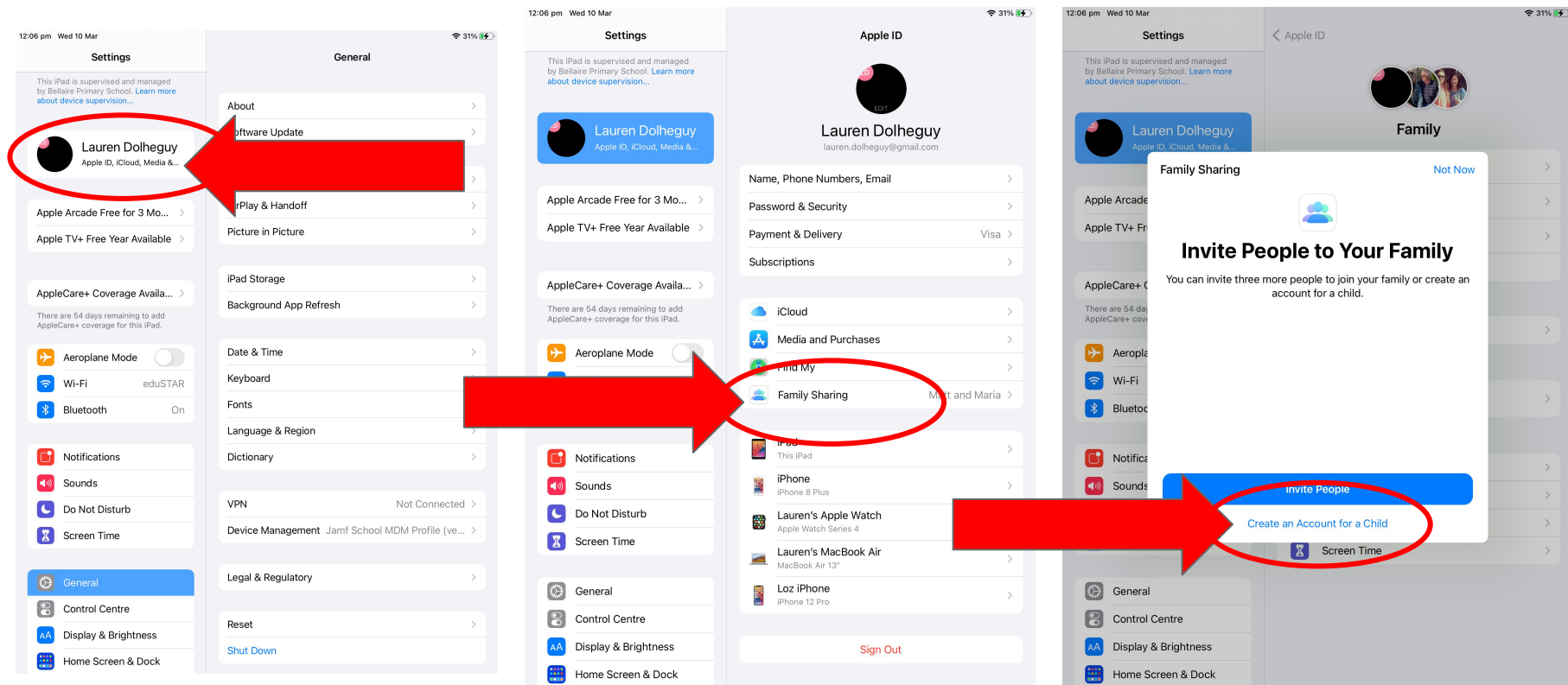

# NOW ONTO CONTENT RESTRICTIONS

Follow the step by step instructions along with photos to help you set up screen time restrictions on your child's iPad whilst at home.

# IN SETTINGS, CLICK ON 'SCREEN TIME, THEN CLICK HERE...

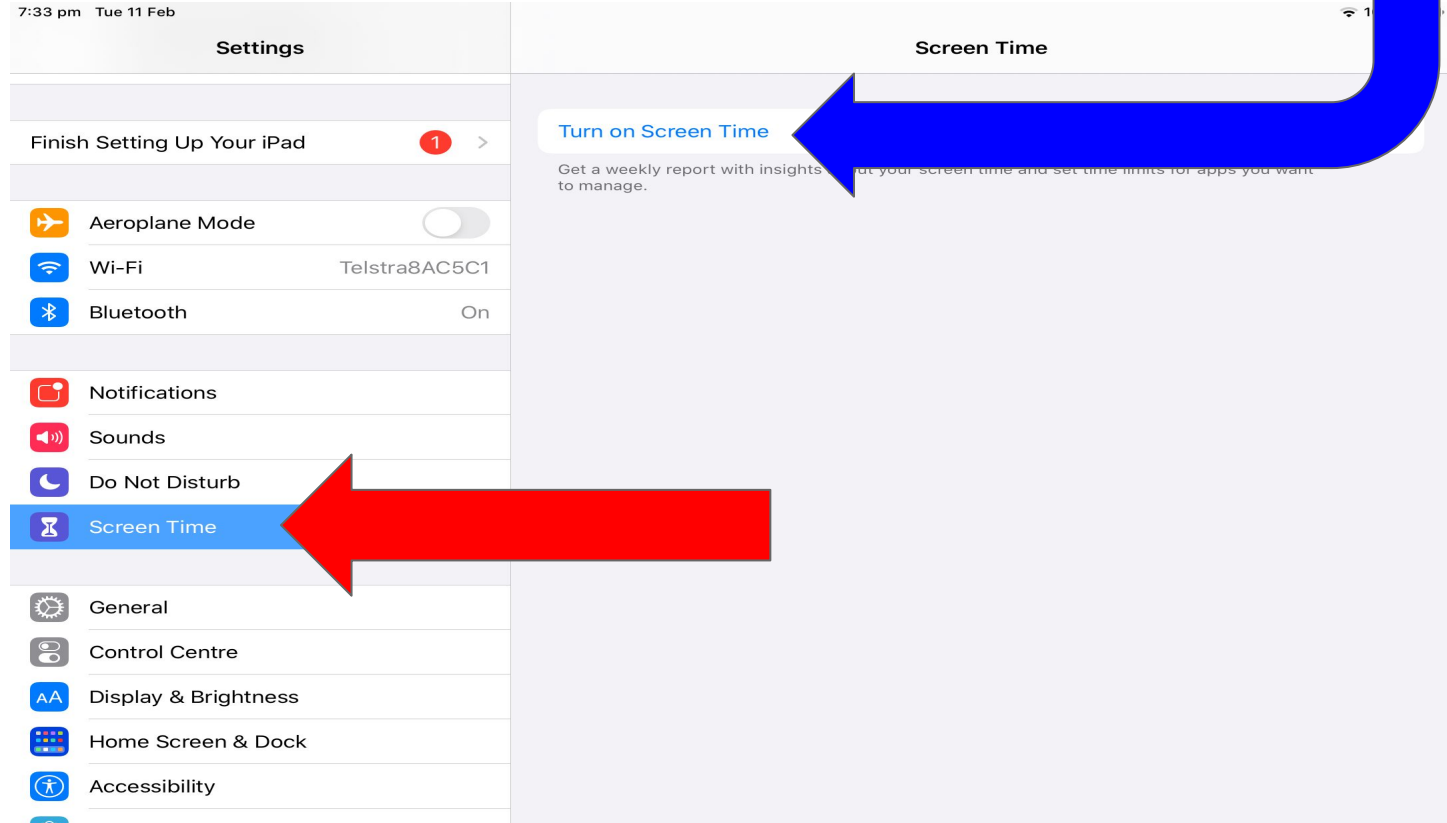

# CLICK CONTINUE...

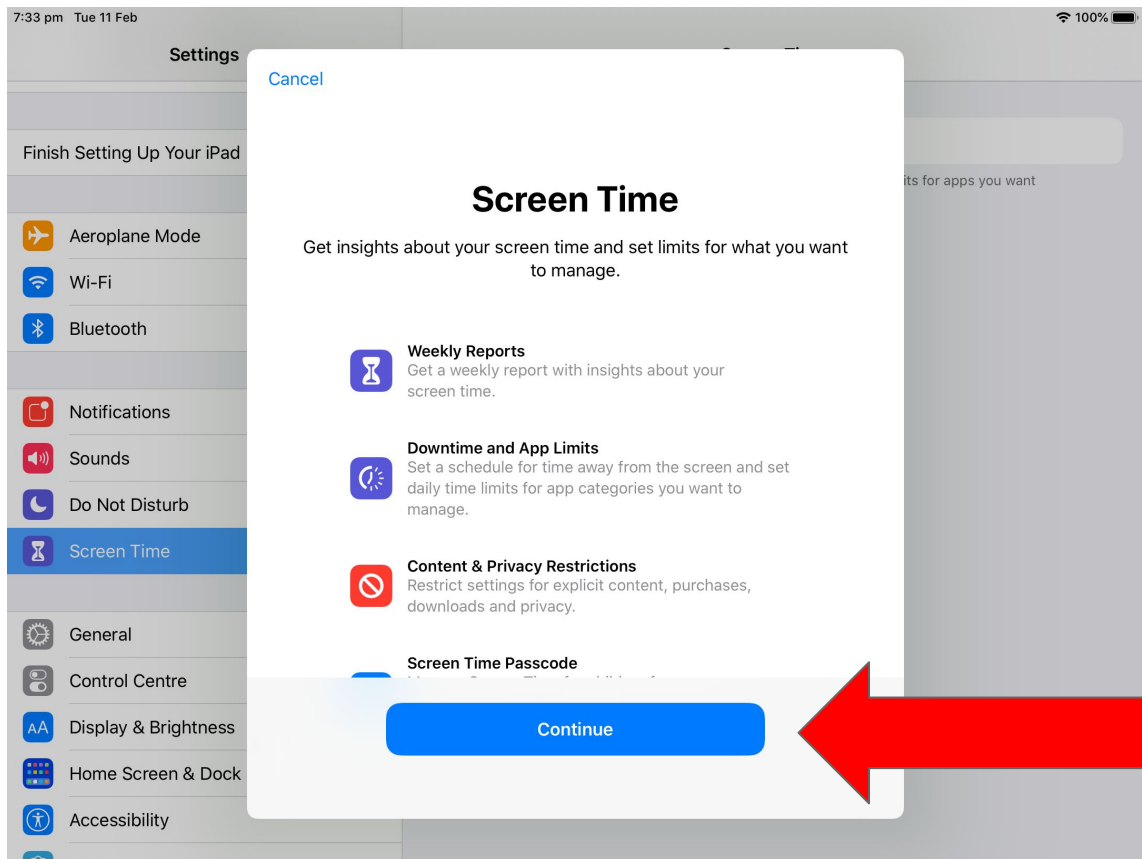

# SELECT 'THIS IS MY CHILD'S IPAD...

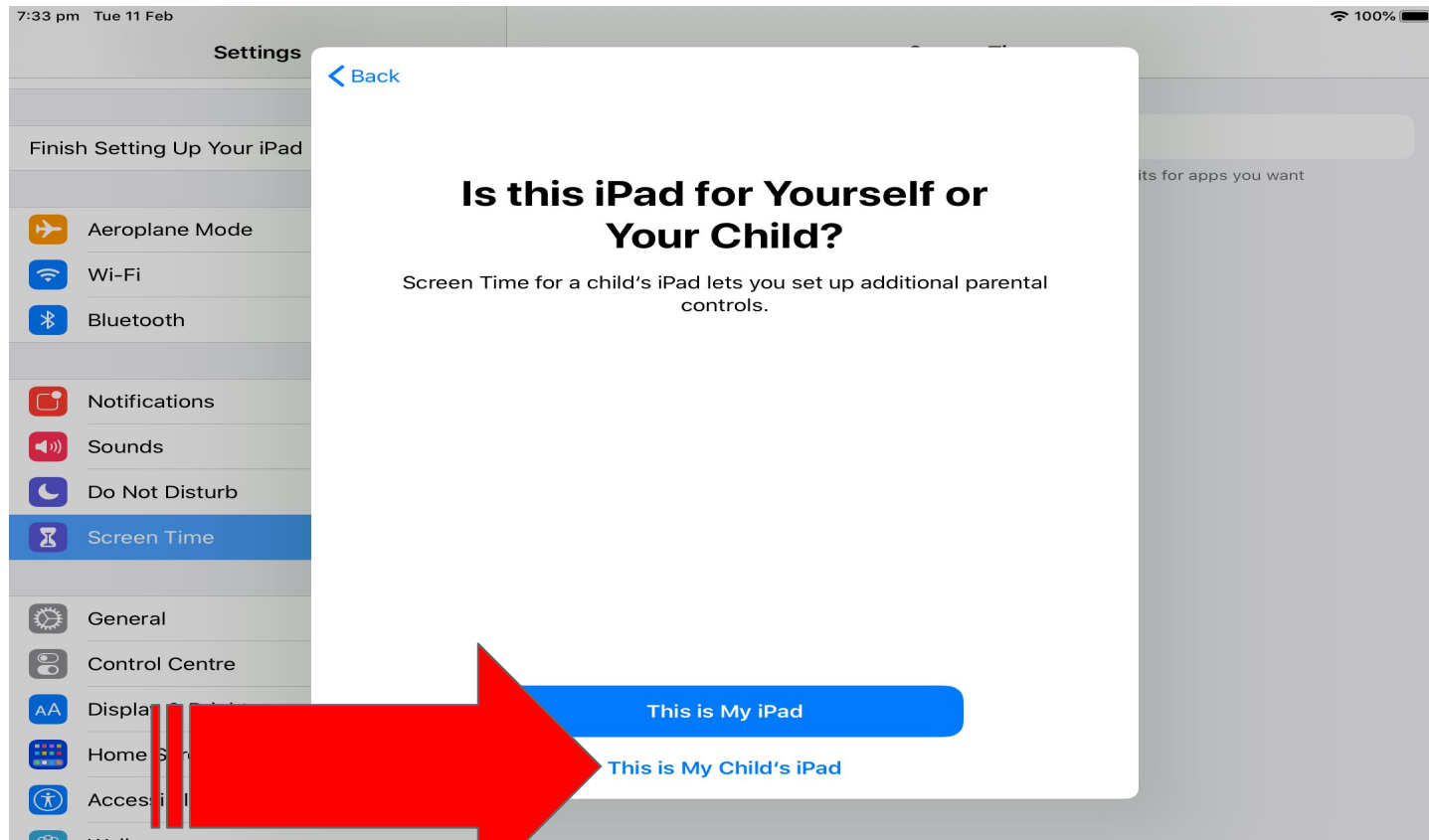



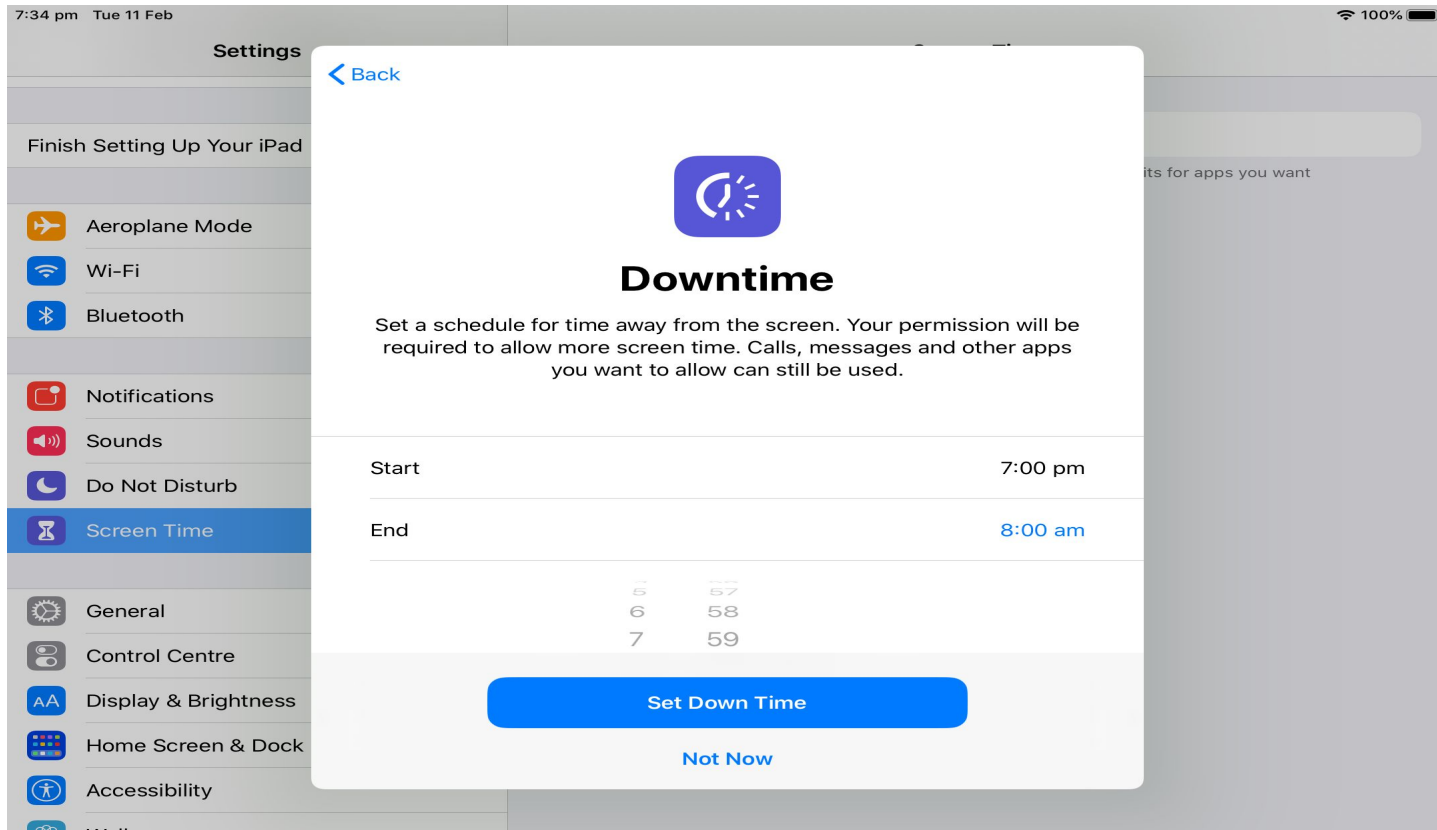

# IT WILL THEN PROMPT YOU TO COMPLETE THESE...



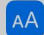

## Settings

Finish Setting Up Your iPad

 Aeroplane Mode Wi-Fi Bluetooth Notifications Sounds Do Not Disturb Screen Time General Control Centre Display & Brightness Home Screen & Dock Accessibility[< Back](#)

## App Limits



Set daily time limits for app categories you want to manage. After a limit has been reached, your permission will be required to allow more time.

- ☒  All Apps and Categories
- ☐  Social Networking
- ☐  Games

[Set App Limit](#)[Not Now](#)

## Settings

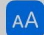
Finish Setting Up Your iPad

 Aeroplane Mode Wi-Fi Bluetooth Notifications Sounds Do Not Disturb Screen Time General Control Centre Display & Brightness Home Screen & Dock Accessibility[< Back](#)

## Content and Privacy

You can customise content and privacy settings in Screen Time settings.



### Restrict Content

You can restrict explicit and mature content in the iTunes and App Stores, Music and websites.



### Restrict Privacy Settings

You can require your permission to make changes to privacy settings.

[Continue](#)

BUT IT'S OFTEN EASIER FROM THIS PAGE, SO CLICK 'NOT NOW'

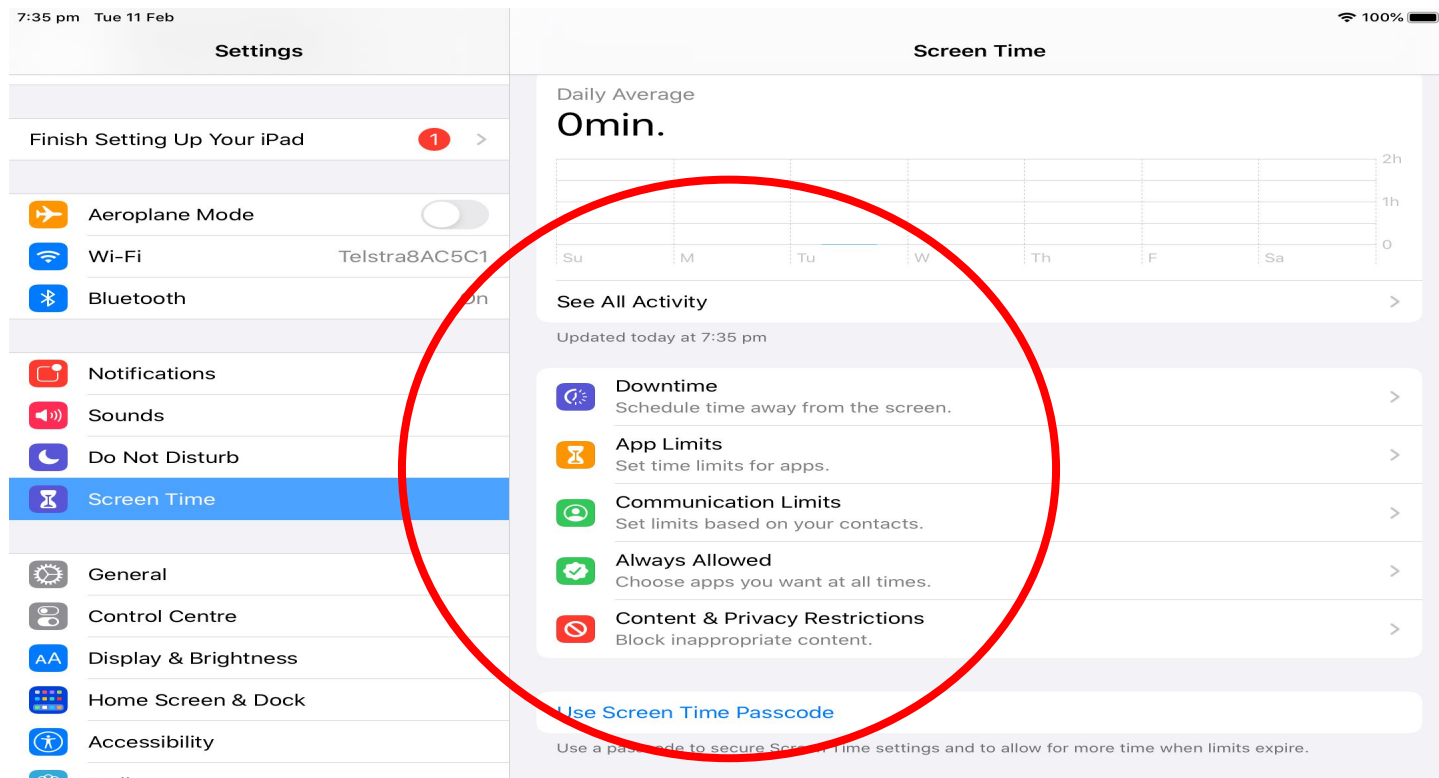

ALL THE FOLLOWING SETTINGS SHOULD BE APPLIED 'BEHIND'  
A SCREEN TIME PASSCODE, WHICH MUST BE DIFFERENT TO THE  
PASSCODE TO UNLOCK YOUR IPAD. THIS IS HOW YOU CAN  
ENSURE ONLY YOU  
MAKE ANY CHANGES...

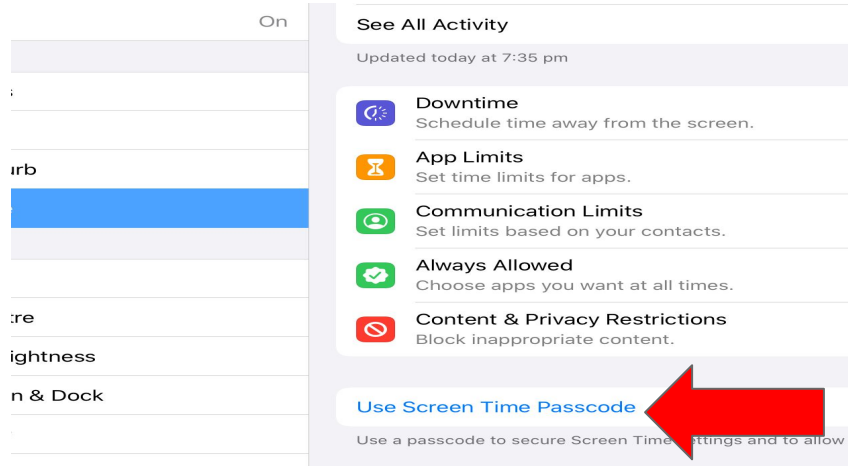

SCREEN TIME HOME PAGE ALLOWS YOU TO SEE ALL ACTIVITY AS AN AVERAGE PER DAY, HOW MANY MINUTES, AND, IF YOU CLICK ON IT, HOW MUCH TIME IN EACH APP.

\*\*PLEASE BE AWARE IF YOU ARE SHARING DEVICES/APPLE ID (PHONE, IPAD ETC) IT WILL COMBINE THEM ALL, SO DON'T BE ALARMED WHEN YOUR INSTAGRAM TIME SHOWS UP IN HERE!! :)

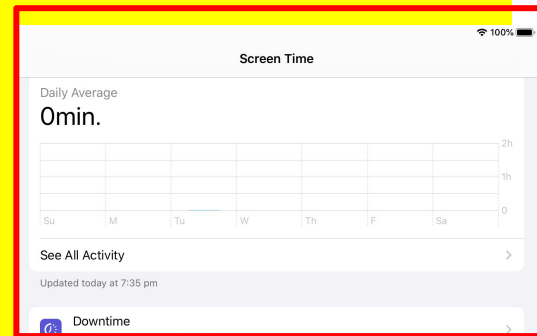

DOWNTIME ALLOWS YOU TO DETERMINE WHEN CERTAIN APPS ARE 'RESTED'. FOR EXAMPLE, YOUTUBE CAN BE DISABLED DURING BEDTIME, OR ANY OTHER APP FOR THAT MATTER!

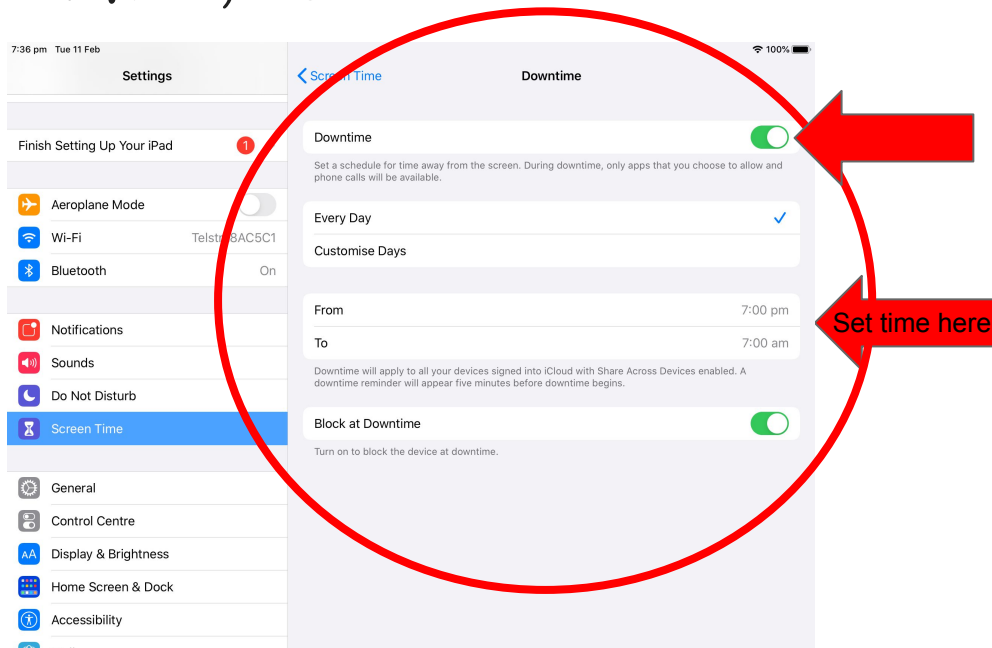

APP LIMITS ALLOWS YOU TO SET TIME LIMITS ON APPS,  
USING CATEGORIES  
SUCH AS GAMES &  
ENTERTAINMENT ETC.

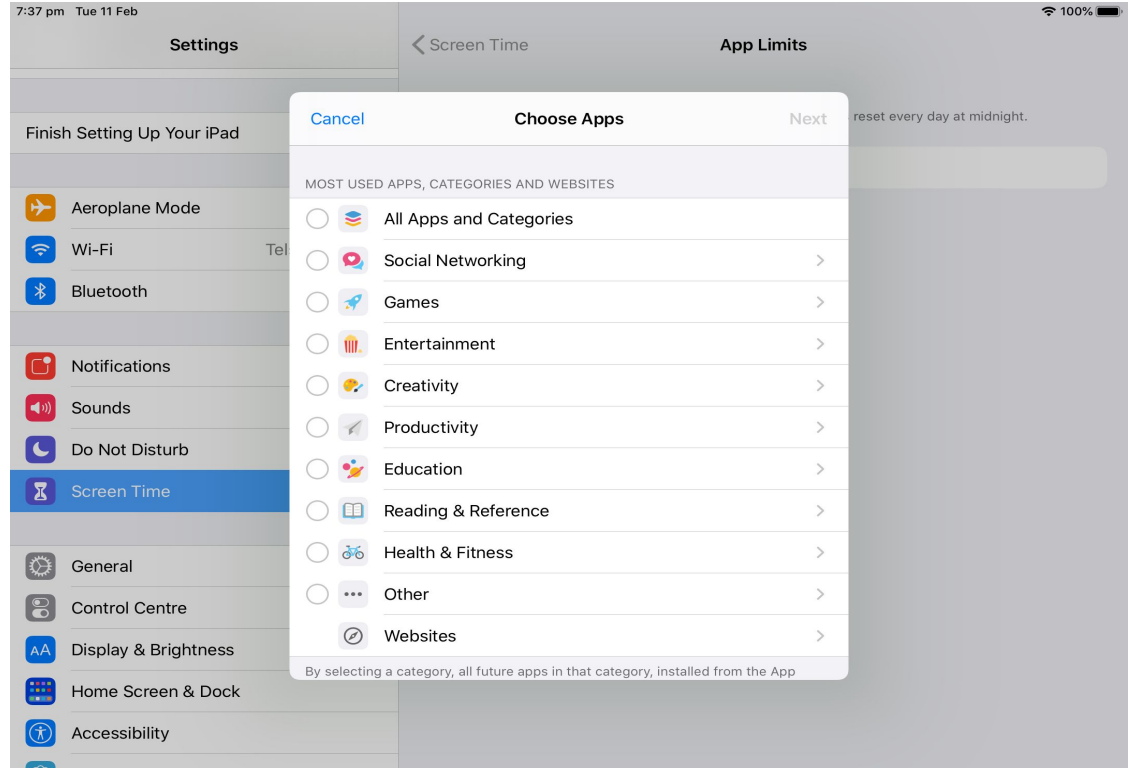

CONTENT & PRIVACY RESTRICTIONS NEED TO BE TURNED ON... THEN CLICK EACH OF THE THREE TABS AS BELOW...

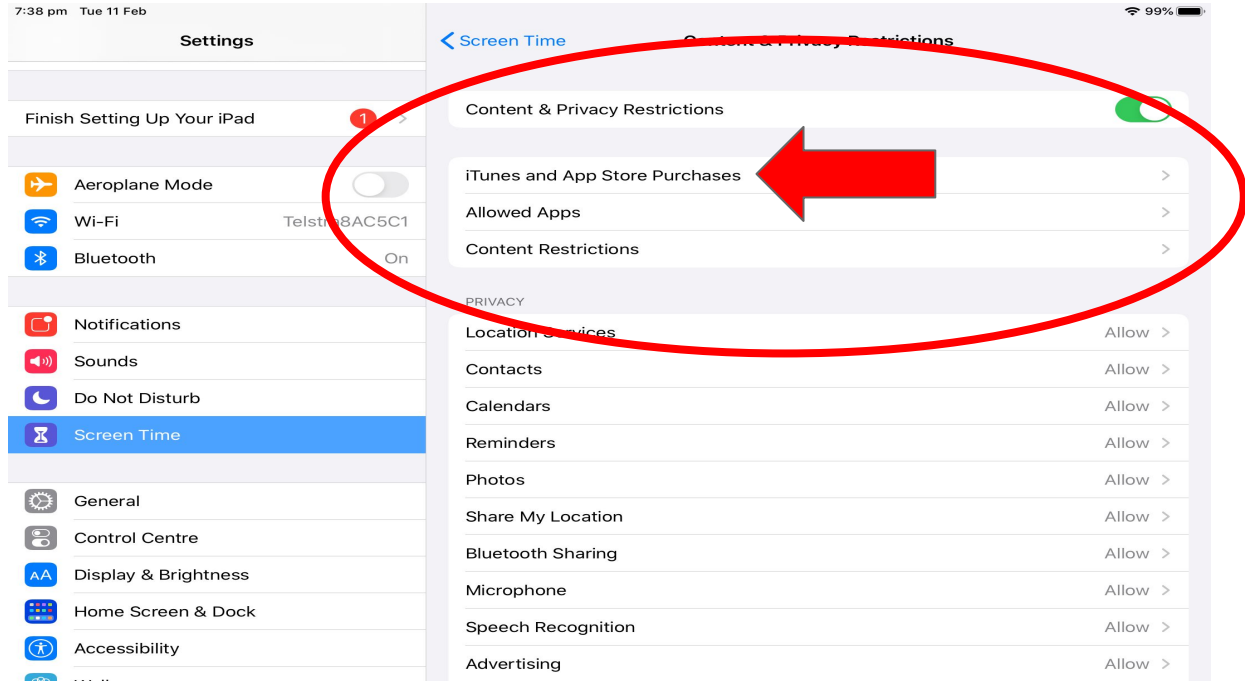

'DON'T ALLOW' ALL 3 OPTIONS, ALONG WITH 'ALWAYS REQUIRE' PASSWORD GIVES YOU COMPLETE CONTROL OVER APP INSTALLATION.

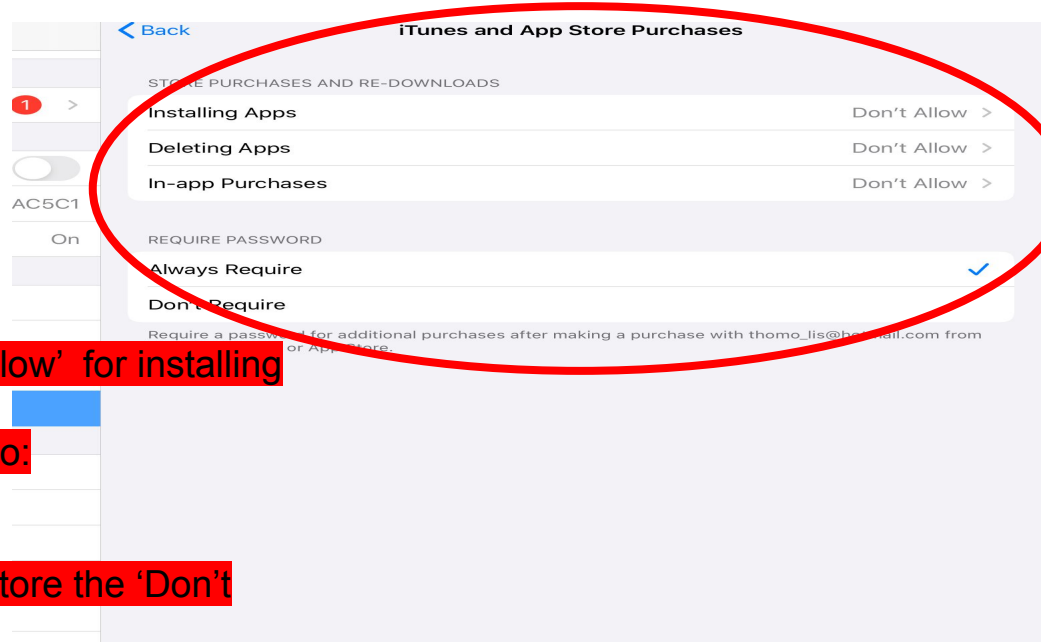

**\*Please note, by checking 'Don't Allow' for installing apps it will remove the app store. For future purchases you will need to:**

- 1. 'Allow' purchasing apps,**
- 2. Purchase the apps you require,**
- 3. Then go back in to settings to restore the 'Don't Allow' feature.**

# 'ALLOWED APPS' TURNS ON OR OFF VARIOUS APPLE APPS...

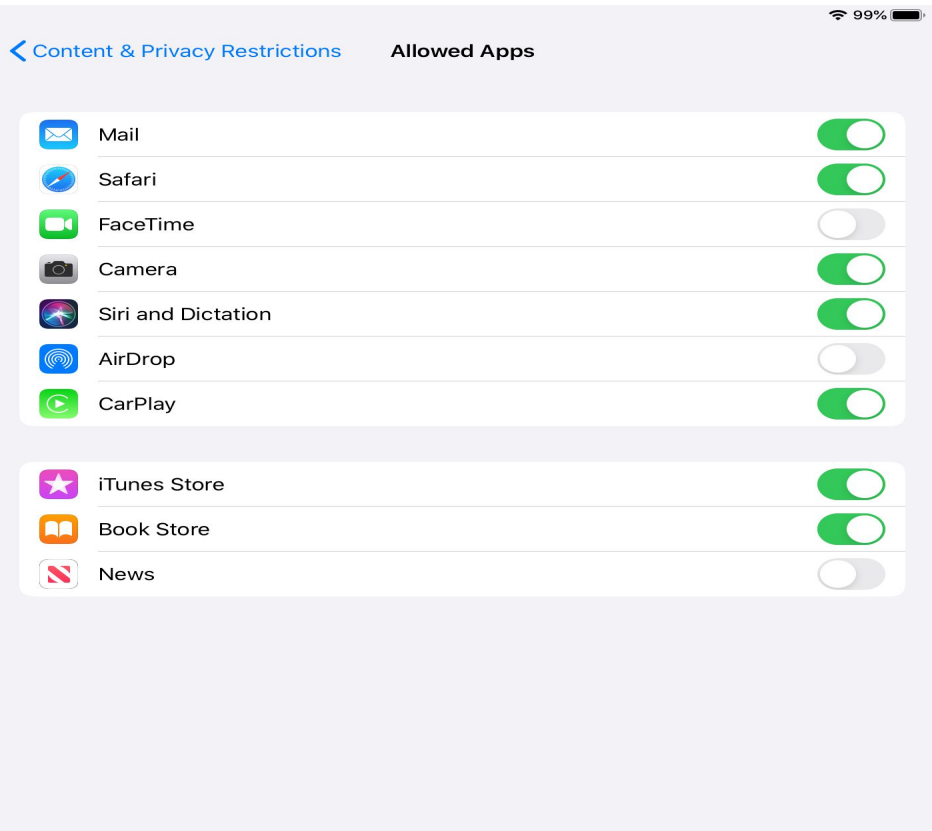
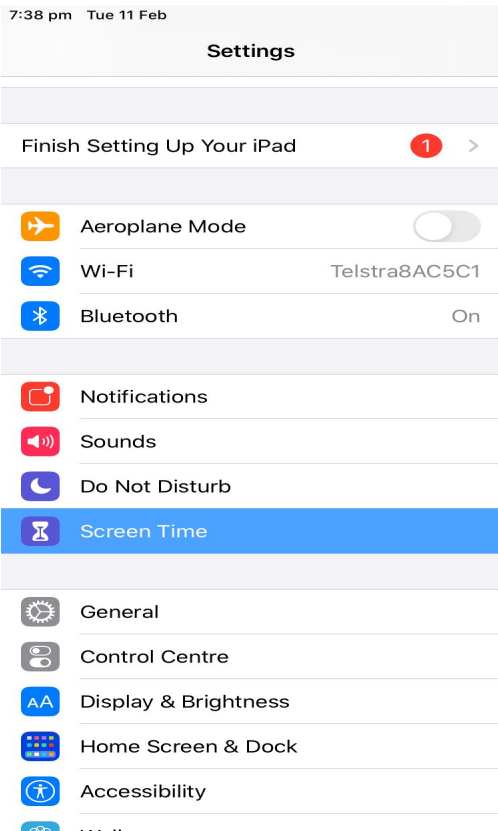

# 'DON'T ALLOW CHANGES' LOCKS YOUR CURRENT SETTINGS...

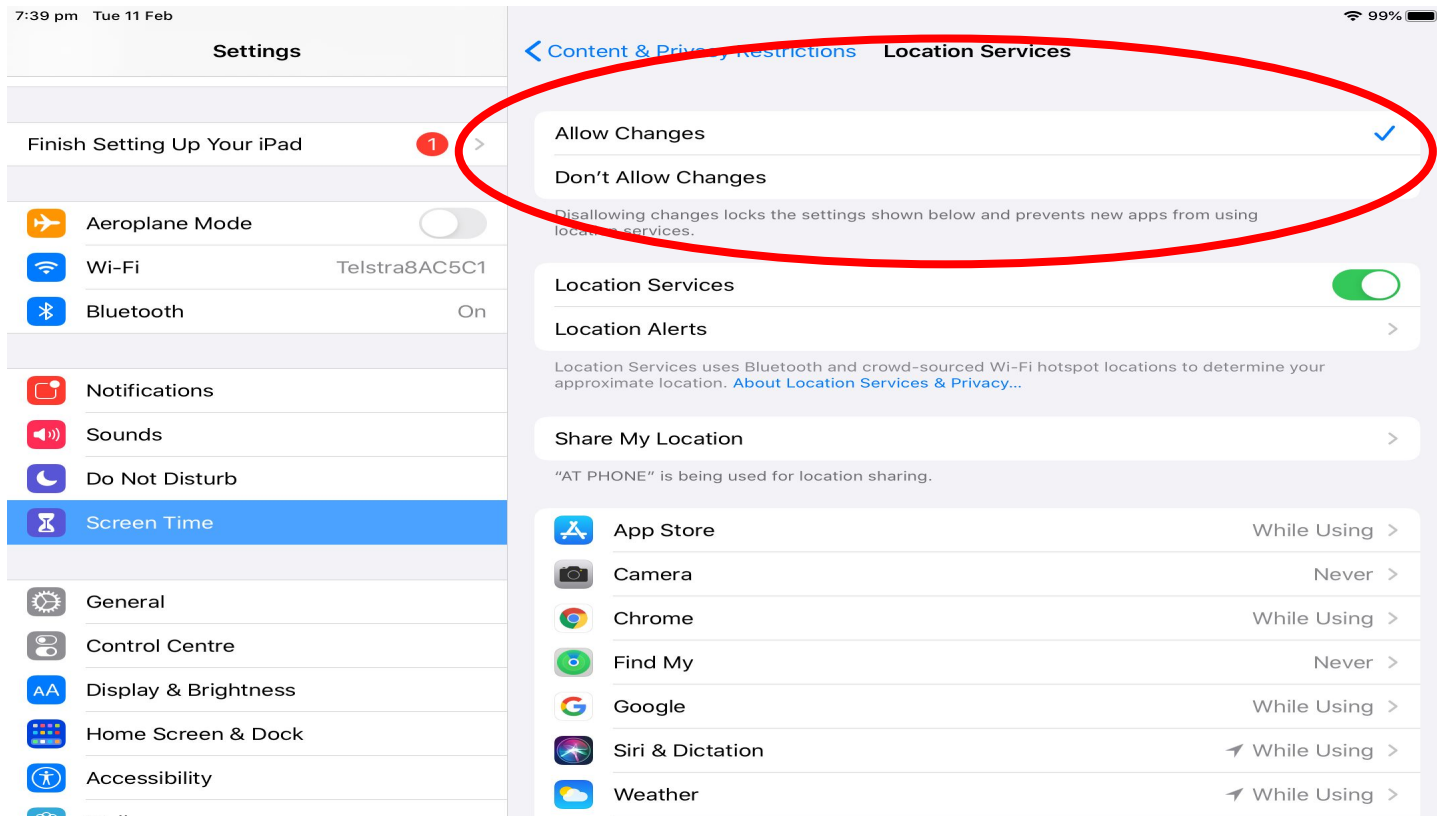

LOCATION SERVICES 'PINGS' YOUR LOCATION. 'WHILE USING' IS OFTEN A SUITABLE SETTING AS NEVER BLOCKS SUGGESTIONS AND MAPS/GOOGLE EARTH ETC.

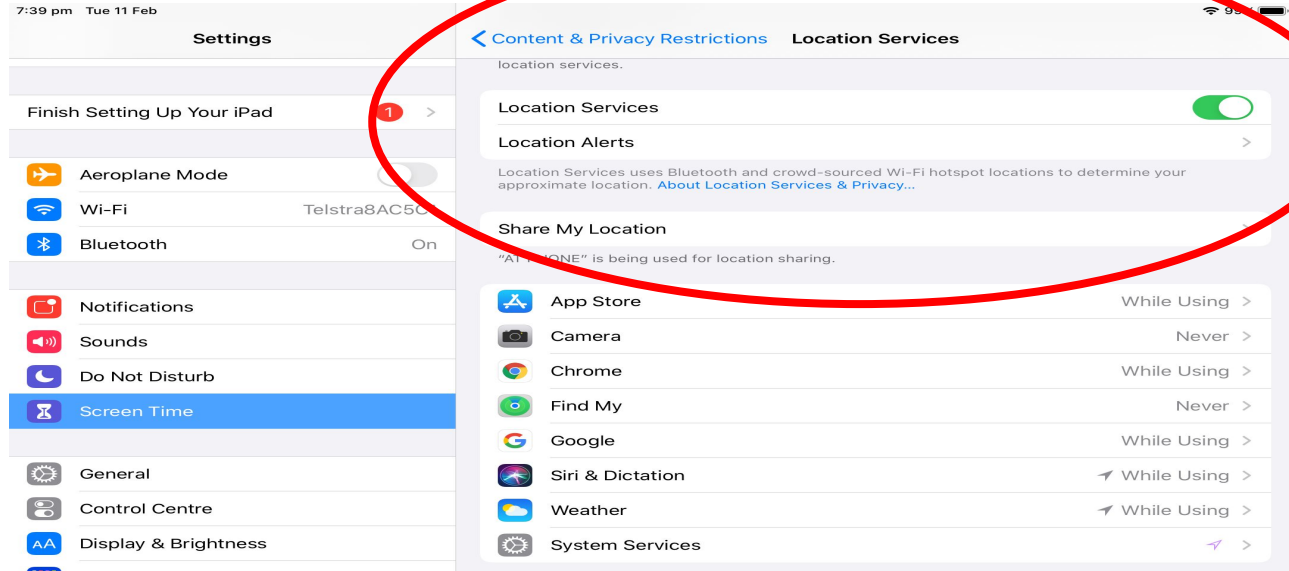

# LOCK PASSWORD, MOBILE AND ACCOUNT CHANGES...

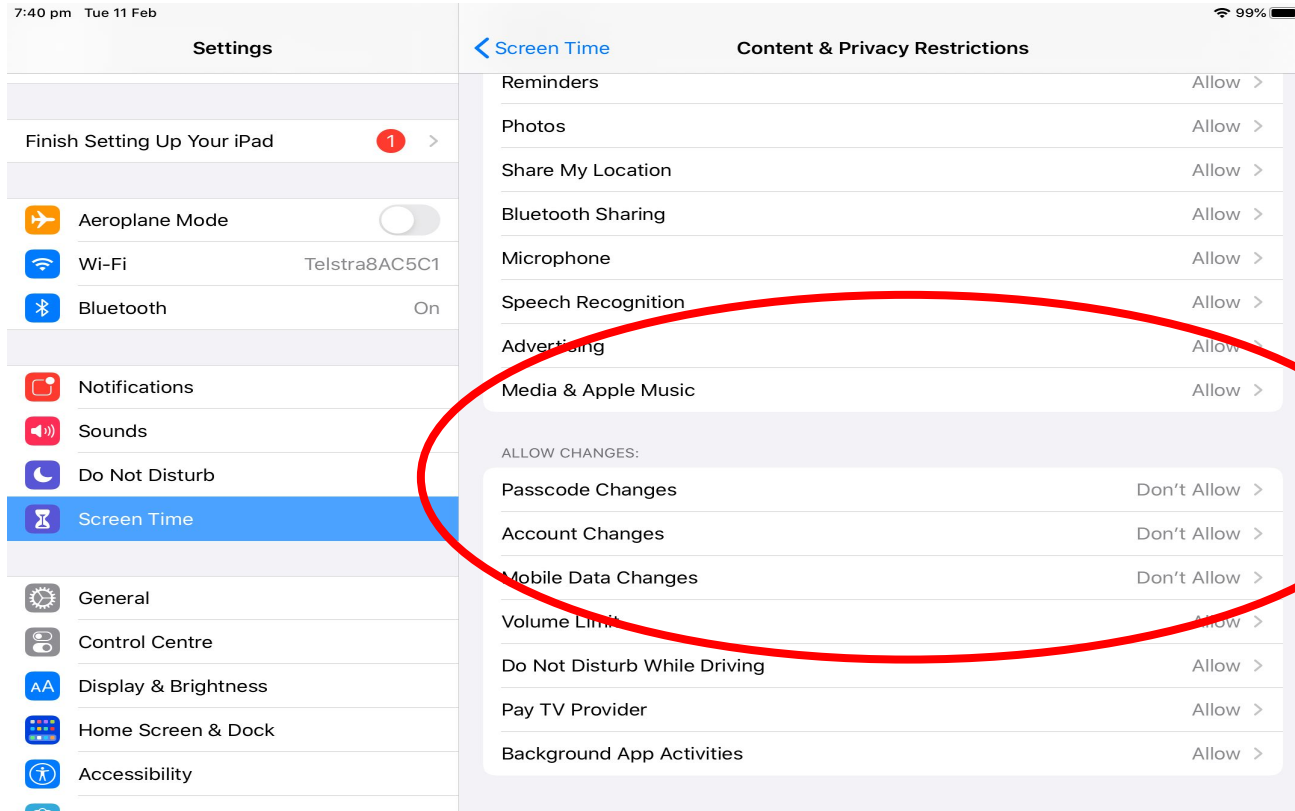

# ADVERTISING CAN BE BLOCKED

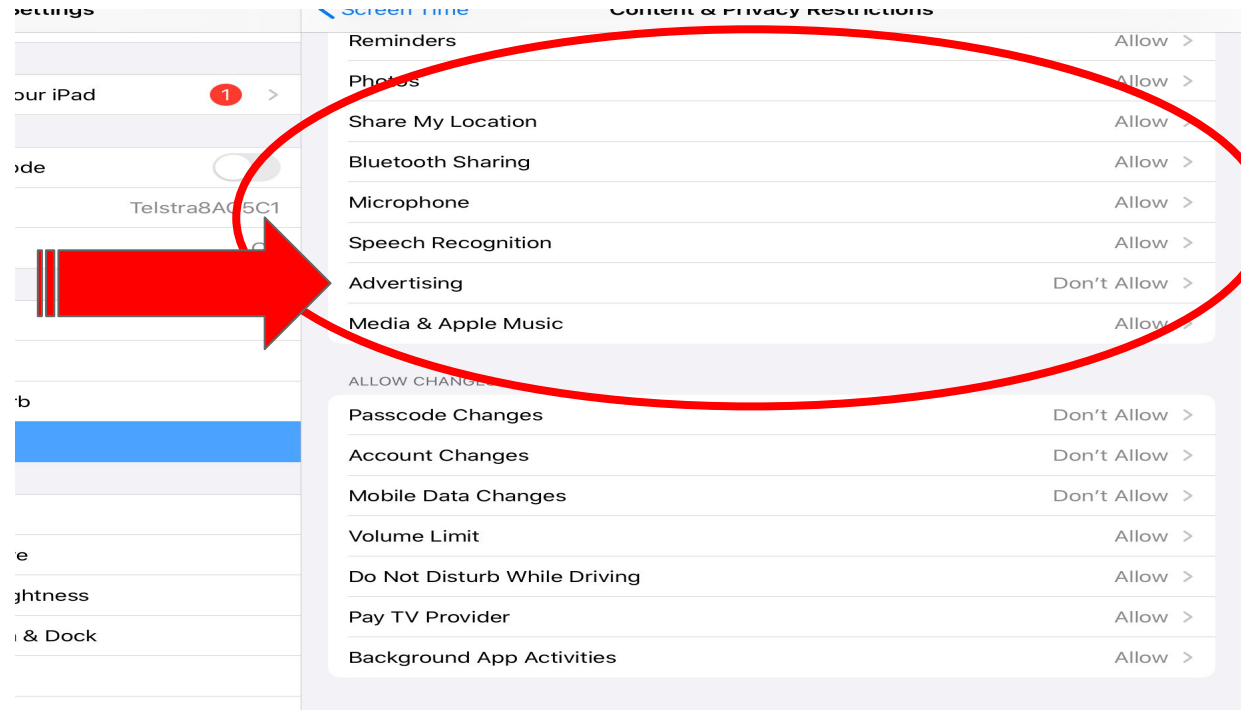

HERE IS THE BIG ONE. BELOW ARE THE SETTINGS FOR  
LANGUAGE AND CONTENT...

